

STAINLESS STEEL FITTINGS

Ref. : DS 2000

Rev. : 6

Date : 02/11

Page 1/3



Valves and fittings

90 rue du ruisseau 38297 ST QUENTIN FALLAVIER
Tel:(33)04.74.94.15.90 Fax:(33)04.74.95.62.08
E mail : sferaco@sferaco.fr

SPECIFICATIONS :

- . "Lost wax" moulding
- . Male BSPT threaded
- . Female BSPP threaded
- . Threaded according to ISO 7/1

USE :

- . Max Pressure Ps : 20 bars
- . Min and max Temperature Ts : -25°C to + 180°C

RANGE :

- . 1/8" to 4"

MATERIALS :

- . SS 316 except for Ref. 2034,2038,2039,2040 in SS 316L

SIZE :

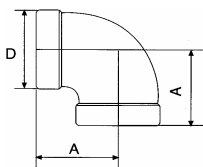

. Elbow 90° F/F Ref. 2001

DN	1/8"	1/4"	3/8"	1/2"	3/4"	1"	1" 1/4"	1" 1/2"	2"	2" 1/2"	3"	4"
A	16	21	25	28	33	38	45	50	60	63	78	96
D	15	19	23	28	34	43	52	57	70	87	107	138
Weight	0,02	0,036	0,06	0,089	0,14	0,21	0,35	0,42	0,64	1,375	2,17	3,93

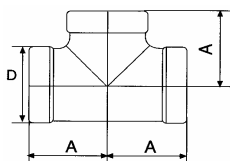

. Tee F/F/F Ref. 2003

DN	1/8"	1/4"	3/8"	1/2"	3/4"	1"	1" 1/4"	1" 1/2"	2"	2" 1/2"	3"	4"
A	16	21	25	28	33	38	45	50	58	65	78	96
D	15	19	23	28	34	43	52	57	70	87	107	138
Weight	0,032	0,048	0,077	0,127	0,191	0,29	0,46	0,523	0,802	1,81	2,44	4,78

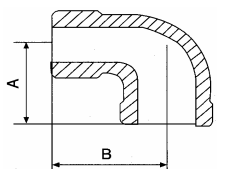

. Elbow 90° M/F Ref. 2010

DN	1/8"	1/4"	3/8"	1/2"	3/4"	1"	1" 1/4"	1" 1/2"	2"	2" 1/2"	3"
A	17	21	23	27	32	38	45	48	57	69	78
B	27	28	29	35	40	46	54	57	70	83	94
Weight	0,021	0,032	0,055	0,094	0,144	0,245	0,35	0,43	0,705	1,61	2,485

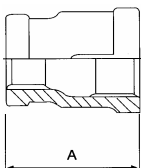

. Reduced nipple female/female Ref. 2013/2014

DN1	1/4"	3/8"	3/8"	1/2"	1/2"	3/4"	3/4"	1"	1"	1" 1/4"	1" 1/4"	1" 1/2"	1" 1/2"	2"	2"
DN2	1/8"	1/8"	1/4"	1/4"	3/8"	3/8"	1/2"	1/2"	3/4"	3/4"	1"	1"	1" 1/4"	1" 1/4"	1" 1/2"
A	27	30	30	36	36	39	39	45	45	50	50	55	55	65	65
Weight	0,039	0,048	0,055	0,062	0,088	0,115	0,129	0,141	0,197	0,276	0,309	0,378	0,402	0,58	0,614

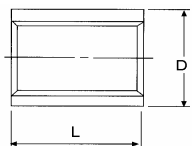

. Socket bright Ref. 2015

DN	1/8"	1/4"	3/8"	1/2"	3/4"	1"	1" 1/4"	1" 1/2"	2"	2" 1/2"	3"	4"
L	18	25	26	34	36	43	48	48	56	65	71	83
D	14	19	22	26	32	40	48	55	66	83	96	122
Weight	0,013	0,031	0,034	0,068	0,084	0,141	0,189	0,245	0,35	0,785	0,966	1,425

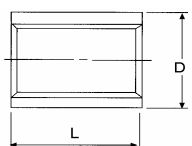

. Half socket Ref. 2017

DN	1/8"	1/4"	3/8"	1/2"	3/4"	1"	1" 1/4"	1" 1/2"	2"
L	10	11	13	16	18	20	22	23	27
D	14	19	22	26	32	40	48	55	66
Weight	0,008	0,014	0,018	0,029	0,038	0,052	0,086	0,095	0,161

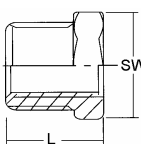

. Reduced nipple male/female Ref. 2021/2024

DN1	1/4"	3/8"	3/8"	1/2"	1/2"	3/4"	3/4"	1"	1"	1" 1/4"	1" 1/4"	1" 1/2"	1" 1/2"	2"	2"
DN2	1/8"	1/8"	1/4"	1/4"	3/8"	3/8"	1/2"	1/2"	3/4"	3/4"	1"	1"	1" 1/4"	1" 1/4"	1" 1/2"
L	19	19	19	22	22	26	26	28	28	33	33	35	35	39	39
SW	16	20	20	23	23	28	28	36	36	46	46	50	50	65	65
Weight	0,014	0,023	0,02	0,037	0,029	0,07	0,05	0,106	0,084	0,178	0,143	0,212	0,145	0,36	0,308

STAINLESS STEEL FITTINGS

Ref. : DS 2000

Rev. : 6

Date : 02/11

Page 2/3



Valves and fittings

90 rue du ruisseau 38297 ST QUENTIN FALLAVIER
Tel:(33)04.74.94.15.90 Fax:(33)04.74.95.62.08
E mail : sferaco@sferaco.fr

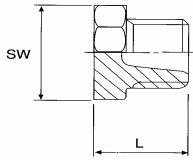

. Hexagon plug Ref. 2022 or 2023 (plain)

DN	1/8"	1/4"	3/8"	1/2"	3/4"	1"	1" 1/4	1" 1/2	2"
L	19	19	19	22	26	28	33	35	39
SW	12	16	19	23	28	36	46	50	65
Weight 2022				0,037	0,059	0,1	0,158	0,2	0,338
Weight 2023	0,03	0,023	0,034	0,061	0,109	0,185	0,359	0,479	0,888

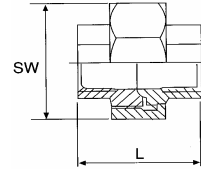

. Union female/female Ref. 2025

DN	1/4"	3/8"	1/2"	3/4"	1"	1" 1/4	1" 1/2	2"
L	42	45	48	52	58	65	70	78
SW	29	34	39	47	58	67	77	90
Weight	0,092	0,119	0,172	0,276	0,407	0,603	0,772	1,179

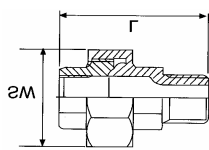

. Union male/female Ref. 2026

DN	1/4"	3/8"	1/2"	3/4"	1"	1" 1/4	1" 1/2	2"
L	55	58	65	70	79	89	94	104
SW	29	34	39	47	58	67	77	90
Weight	0,104	0,138	0,196	0,311	0,473	0,711	0,92	1,357

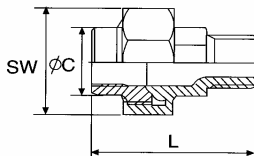

. Welded-screwed union Ref. 2027

DN	3/8"	1/2"	3/4"	1"	1" 1/4	1" 1/2	2"
L	55	62	66	76	84	89	100
SW	34	39	47	58	67	77	90
C	17,2	21,3	26,9	33,7	42,4	48,3	60,3
Weight	0,138	0,196	0,311	0,473	0,711	0,92	1,357

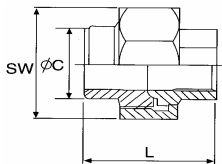

. Welded-threaded union Ref. 2028

DN	3/8"	1/2"	3/4"	1"	1" 1/4	1" 1/2	2"
L	42	45	48	55	59	63	71
SW	34	39	47	58	67	77	90
C	17,2	21,3	26,9	33,7	42,4	48,3	60,3
Weight	0,098	0,132	0,209	0,328	0,487	0,62	0,905

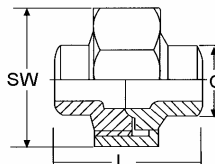

. Welded union Ref. 2029

DN	10	15	20	25	32	40	50
L	38	41	43	51	54	58	66
SW	34	39	47	58	67	77	90
C	17,2	21,3	26,9	33,7	42,4	48,3	60,3
Weight	0,098	0,132	0,209	0,328	0,487	0,62	0,905

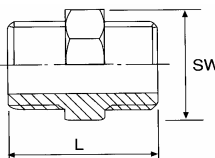

. Hexagon nipple Ref. 2030

DN	1/8"	1/4"	3/8"	1/2"	3/4"	1"	1" 1/4	1" 1/2	2"
L	25	32	29	34	36,5	42	47,5	47,5	57
SW	12	14	19	23	27	36	46	50	65
Weight	0,013	0,024	0,042	0,061	0,093	0,138	0,208	0,25	0,433

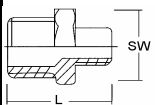

. Reduced nipple male/male Ref. 2031/2032

DN1	1/4"	3/8"	3/8"	1/2"	1/2"	3/4"	3/4"	1"	1"	1"1/4	1"1/4	1"1/2	1"1/2	2"	2"
DN2	1/8"	1/8"	1/4"	1/4"	3/8"	3/8"	1/2"	1/2"	3/4"	3/4"	1"	1"	1" 1/4	1"1/4	1"1/2
L	31	35	35	38	38	41	41	46	47	51	53	55	56	63	64
SW	16	19	19	23	23	29	29	36	36	46	46	54	54	65	65
Weight	0,027	0,036	0,038	0,053	0,057	0,084	0,088	0,109	0,112	0,18	0,18	0,319	0,23	0,525	0,551

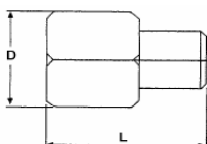

. Reduced nipple Female/Male Ref. 2033

DN1	1/4"	3/8"	1/2"	3/4"	1"	1"1/4	1"1/2	2"
DN2	1/8"	1/4"	3/8"	1/2"	3/4"	1"	1"1/4	1"1/2
L	27	30	35	39	44	47	50	53
D	17	21	26	32	38	46	54	63
Weight	0,023	0,036	0,065	0,1	0,135	0,164	0,263	0,315

STAINLESS STEEL FITTINGS

Ref. : DS 2000

Rev. : 6

Date : 02/11

Page 3/3



Valves and fittings

90 rue du ruisseau 38297 ST QUENTIN FALLAVIER
Tel:(33)04.74.94.15.90 Fax:(33)04.74.95.62.08
E mail : sferaco@sferaco.fr

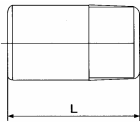

. Welding nipple L = 50 mm Ref. 2034

DN	1/4"	3/8"	1/2"	3/4"	1"	1" 1/4"	1" 1/2"	2"
L	50	50	50	50	50	50	50	50
Weight	0,025	0,039	0,058	0,079	0,093	0,135	0,16	0,215

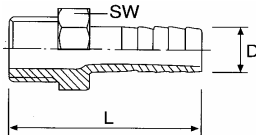

. Hoze nozzle Ref. 2035

DN	1/4"	3/8"	1/2"	3/4"	1"	1" 1/4"	1" 1/2"	2"
L	40	50	60	55	70	81	95	100
SW	15	19	23	29	38	46	52	63
D	8,9	11,5	14	19,5	26	34	40	52
Weight	0,03	0,049	0,083	0,113	0,22	0,295	0,406	0,67

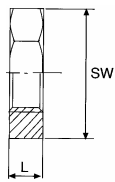

. Hexagon nut Ref. 2036

DN	1/8"	1/4"	3/8"	1/2"	3/4"	1"	1" 1/4"	1" 1/2"	2"
L	6	6	7	8	9	10	11	12	13
SW	19	22	27	32	37	46	55	62	76
Weight	0,011	0,014	0,023	0,036	0,047	0,079	0,11	0,15	0,219

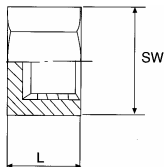

. Hexagon cap female Ref. 2037

DN	1/4"	3/8"	1/2"	3/4"	1"	1" 1/4"	1" 1/2"	2"
L	15	18	22	25	28	30	31	36
SW	18	22	26	32	39	48	54	69
Weight	0,023	0,039	0,062	0,099	0,147	0,23	0,29	0,565

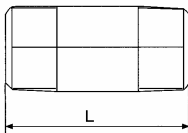

. Barrel nipple L = 100 mm Ref. 2038

DN	1/4"	3/8"	1/2"	3/4"	1"	1" 1/4"	1" 1/2"	2"
L	100	100	100	100	100	100	100	100
Weight	0,062	0,078	0,105	0,153	0,185	0,247	0,345	0,425

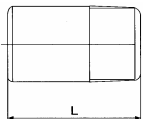

. Standard welding nipple Ref. 2039

DN	1/4"	3/8"	1/2"	3/4"	1"	1" 1/4"	1" 1/2"	2"	2" 1/2"	3"	4"
L	22	23	27	33	35	36	41	46	55	70	80
Weight	0,012	0,017	0,029	0,044	0,06	0,074	0,095	0,185	0,25	0,635	1,065

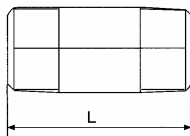

. Standard barrel nipple Ref. 2040

DN	1/4"	3/8"	1/2"	3/4"	1"	1" 1/4"	1" 1/2"	2"	2" 1/2"	3"	4"
L	40	40	60	60	60	80	80	100	100	120	120
Weight	0,023	0,028	0,065	0,085	0,1	0,175	0,195	0,425	0,428	1,155	1,575

STANDARDS :

. DIRECTIVE 97/23/CE : Products excluded from directive (Article 1,§3.2)

. Size according to ISO 4144

ADVICE : Our opinion and our advice are not guaranteed and SFERACO shall not be liable for the consequences of damages. The customer must check the right choice of the products with the real service conditions.